



설치 설명서

Club 322F

Club 3412T

Club 422F

Club 522F

Club 602C

Club 602CTP

Club 620F

Club 622

Club 6422F

Club 8622F

Club 9632

Club 322F

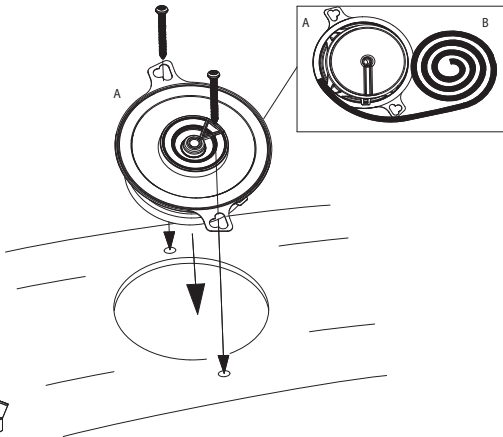
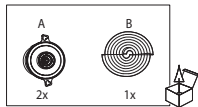
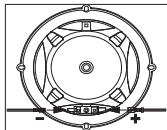

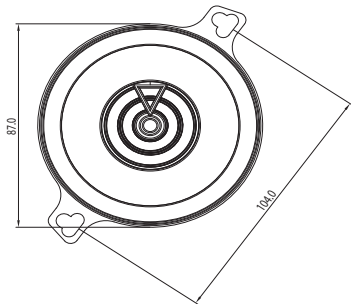
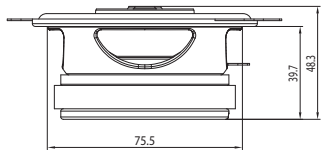

사양

- 타입: 3-1/2" (87mm) 투웨이 차량용 스피커
- 출력 처리 용량: 25W RMS, 최대 75W
- 감도 (@ 2.83V/m): 89dB
- 주파수 응답: 90Hz – 20kHz
- 공칭 임피던스: 3.0 ohms

틸/스몰 파라미터

- BL (Tm): 2.873
- DCR (ohms): 2.26
- Mms (g): 3.723
- Sd (cm²): 44.18
- Cms (μm/N): 0.491
- Vas (l): 1.3574
- Fs (Hz): 117.7
- Qes: 0.755
- Qms: 7.777
- Qts: 0.688
- Crossover Point: 4kHz

Club 3412T

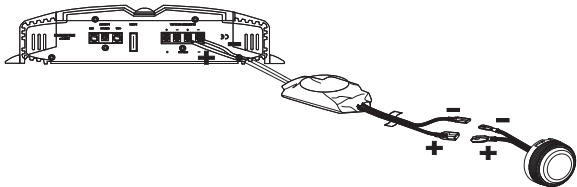
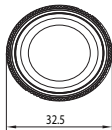
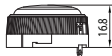

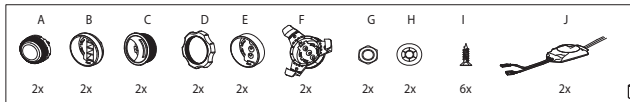
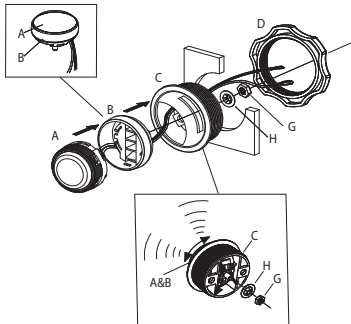
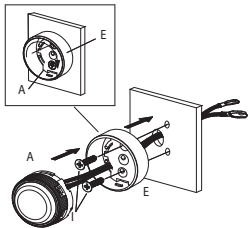

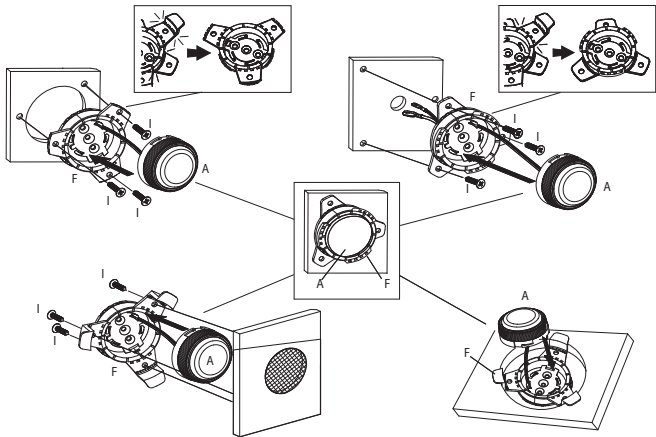

사양

- 타입: 3/4" (19mm) Edge-driven 돔 트위터
- 출력 처리 용량: 50W RMS, 최대 150W
- 감도 (@ 2.83V): 92dB
- 주파수 응답: 3kHz – 20kHz
- 공칭 임피던스: 3.0 ohms

Club 422F

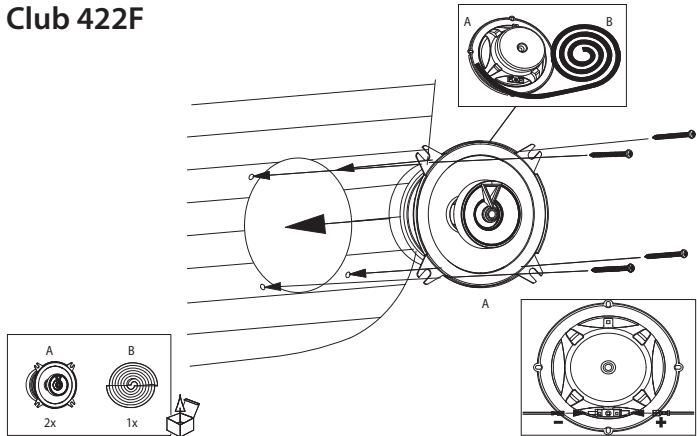

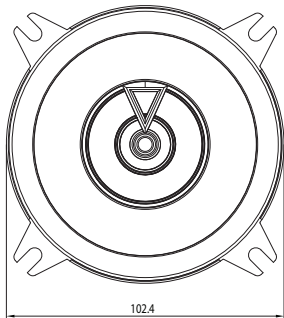
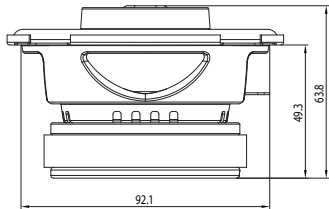

사양

- 타입: 4" (100mm) 투웨이 차량용 스피커
- 출력 처리 용량: 35W RMS, 최대 105W
- 감도 (@ 2.83V): 90dB
- 주파수 응답: 75Hz – 20kHz
- 공칭 임피던스: 3.0 ohms

틸/스몰 파라미터

- BL (Tm): 3.783
- DCR (ohms): 2.46
- Mms (g): 6.608
- Sd (cm²): 63.62
- Cms ($\mu\text{m}/\text{N}$): 0.750
- Vas (l): 4.2937
- Fs (Hz): 71.5
- Qes: 0.510
- Qms: 6.495
- Qts: 0.473
- Crossover Point: 3kHz

Club 522F

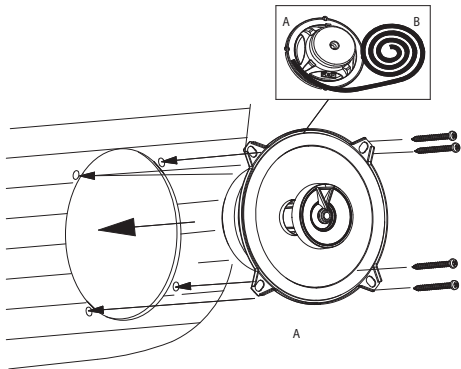
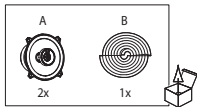
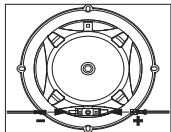

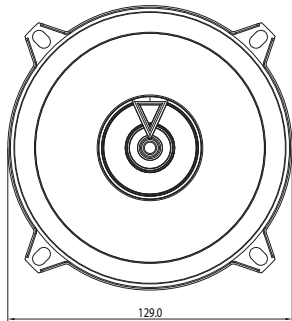
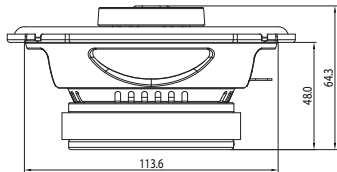

사양

- 타입: 5-1/4" (130mm) 투웨이 차량용 스피커
- 출력 처리 용량: 45W RMS, 최대 135W
- 감도 (@ 2.83V): 91dB
- 주파수 응답: 75Hz – 20kHz
- 공칭 임피던스: 3.0 ohms

틸/스몰 파라미터

- BL (Tm): 3.563
- DCR (ohms): 2.24
- Mms (g): 9.484
- Sd (cm²): 103.87
- Cms (μm/N): 0.274
- Vas (l): 4.1850
- Fs (Hz): 98.7
- Qes: 1.036
- Qms: 8.608
- Qts: 0.925
- Crossover Point: 3kHz

Club 602C

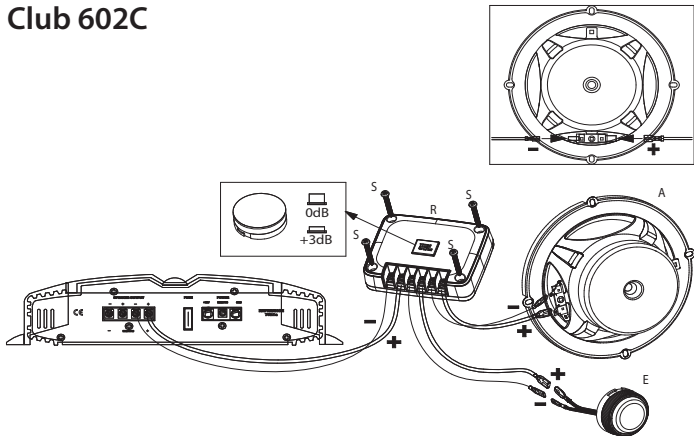

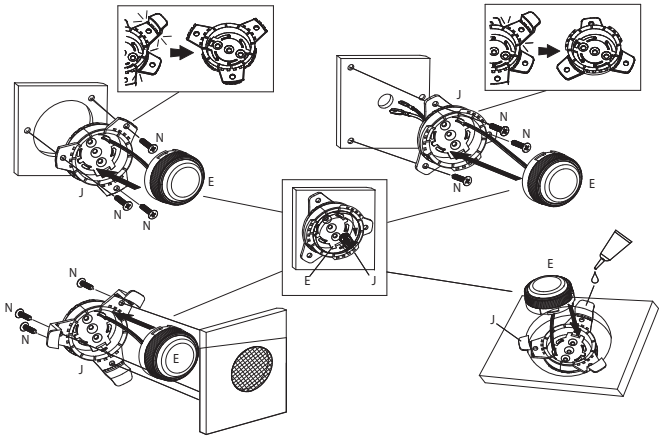

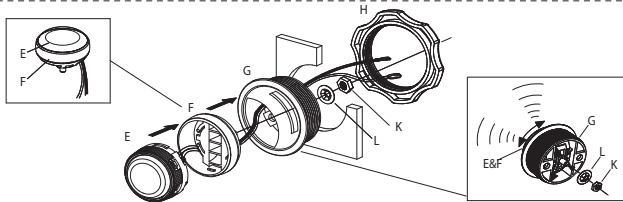
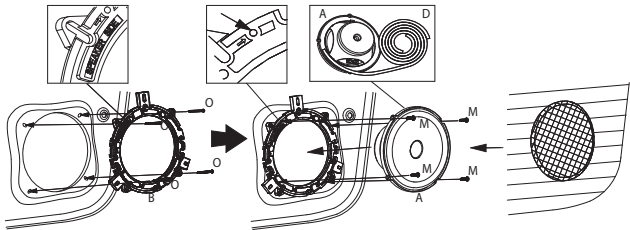

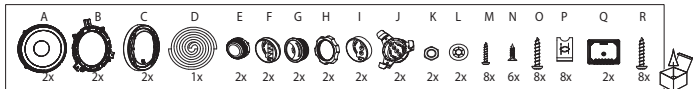
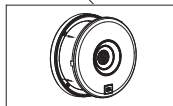
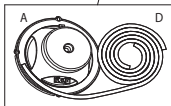
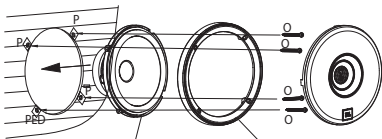
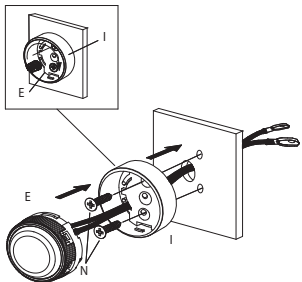

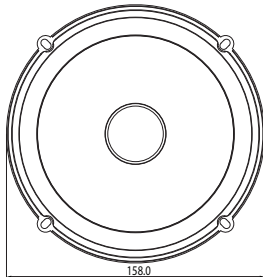
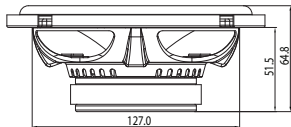
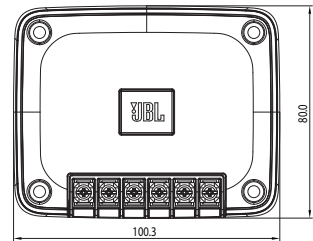

사양

- 타입: 6-1/2" (160mm) 투웨이 컴포넌트 스피커 시스템
- 출력 처리 용량: 70W RMS, 최대 210W
- 감도 (@ 2.83V): 92dB
- 주파수 응답: 55Hz – 20kHz
- 공칭 임피던스: 3.0 ohms

틸/스몰 파라미터

- BL (Tm): 3.635
- DCR (ohms): 2.37
- Mms (g): 14.409
- Sd (cm²): 132.73
- Cms (μm/N): 0.257
- Vas (l): 6.4107
- Fs (Hz): 82.7
- Qes: 1.340
- Qms: 10.965
- Qts: 1.194
- Crossover Point: 5.5kHz

Club 602CTP

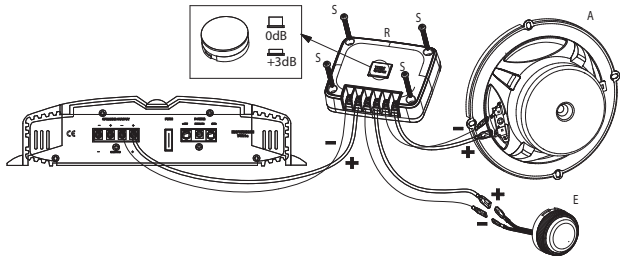
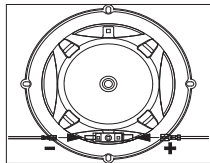

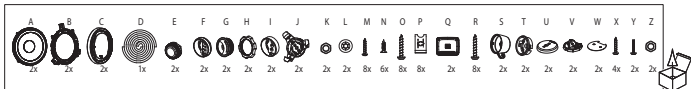
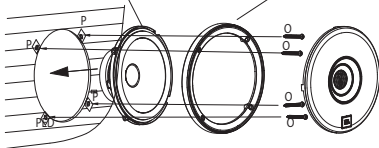
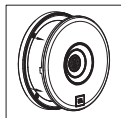
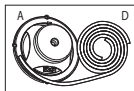
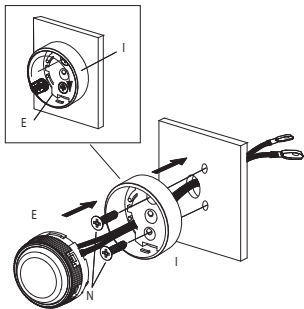

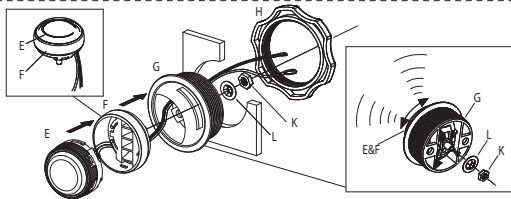
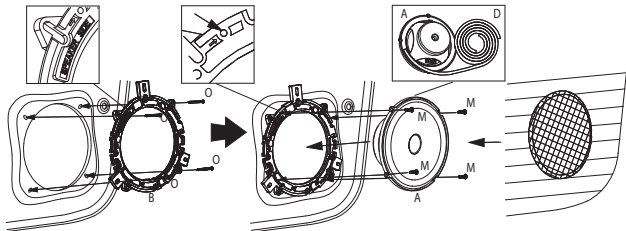

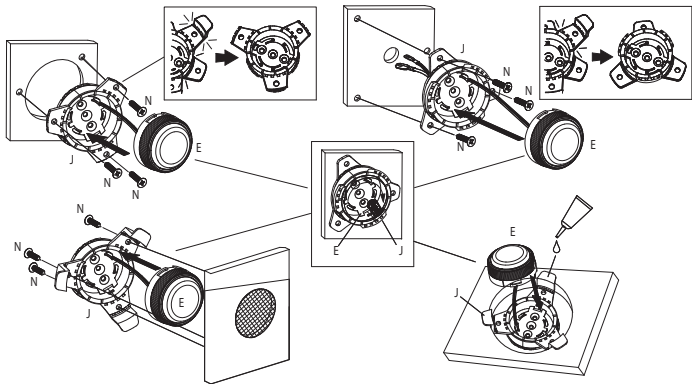

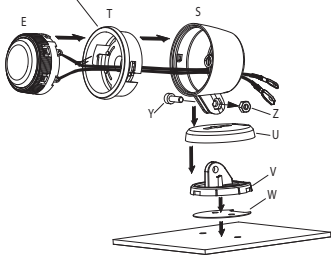
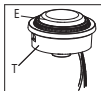
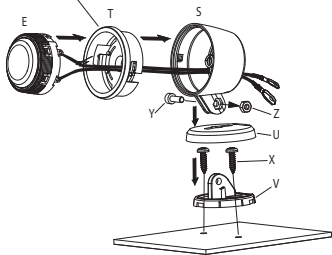
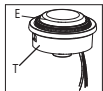

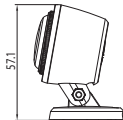
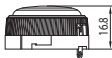
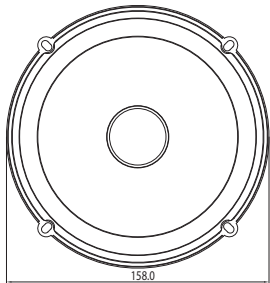
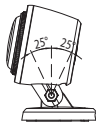
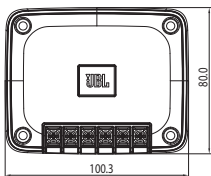
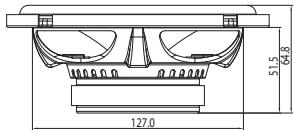

사양

- 타입: 160mm(6.5인치) 양방향 컴포넌트 스피커 시스템, 트위터 팟 포함
- 출력 처리 용량: 70W RMS, 최대 210W
- 감도 (@ 2.83V): 92dB
- 주파수 응답: 55Hz – 20kHz
- 공칭 임피던스: 3.0 ohms

틸/스몰 파라미터

- BL (Tm): 3.635
- DCR (ohms): 2.37
- Mms (g): 14.409
- Sd (cm²): 132.73
- Cms (μm/N): 0.257
- Vas (l): 6.4107
- Fs (Hz): 82.7
- Qes: 1.340
- Qms: 10.965
- Qts: 1.194
- Crossover Point: 5.5kHz

Club 620F

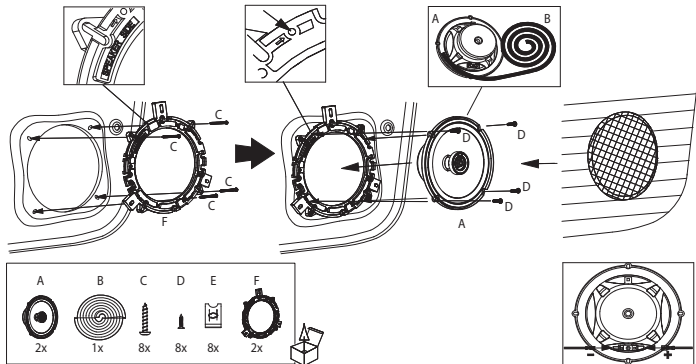

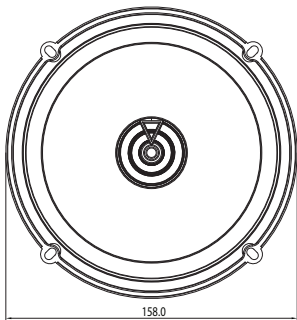
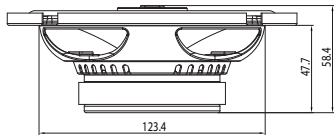

사양

- 타입: 셸로 마운트 6-1/2" (160mm) 투웨이 차량용 스피커
- 출력 처리 용량: 55W RMS, 최대 165W
- 감도 (@ 2.83V): 92dB
- 주파수 응답: 55Hz – 20kHz
- 공칭 임피던스: 3.0 ohms

틸/스몰 파라미터

- BL (Tm): 3.739
- DCR (ohms): 2.41
- Mms (g): 9.934
- Sd (cm²): 122.72
- Cms (μm/N): 0.278
- Vas (l): 5.9287
- Fs (Hz): 95.7
- Qes: 1.032
- Qms: 11.357
- Qts: 0.946
- Crossover Point: 4kHz

Club 622

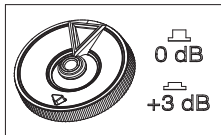
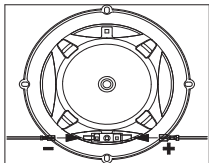

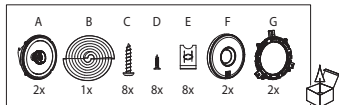
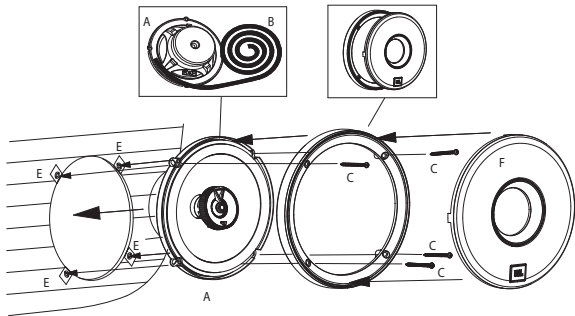

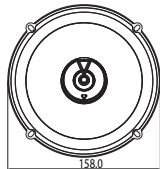
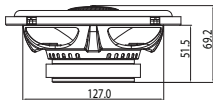
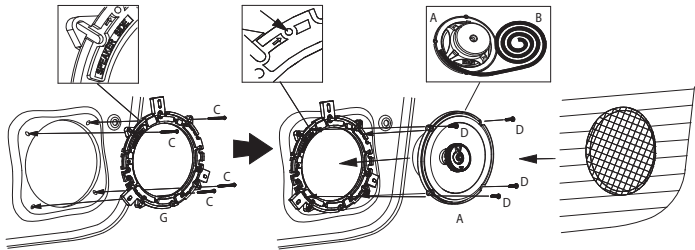

사양

- 타입: 6-1/2" (160mm) 투웨이 차량용 스피커, 더 나은 사운드 성능의 공학 설계.
- 출력 처리 용량: 60W RMS, 최대 180W
- 감도 (@ 2.83V): 93dB
- 주파수 응답: 48Hz – 21kHz
- 공칭 임피던스: 3.0 ohms

틸/스몰 파라미터

- BL (Tm): 3.632
- DCR (ohms): 2.36
- Mms (g): 13.758
- Sd (cm²): 132.73
- Cms (μm/N): 0.378
- Vas (l): 9.4253
- Fs (Hz): 69.8
- Qes: 1.080
- Qms: 10.655
- Qts: 0.980
- Crossover Point: 3.5kHz

Club 6422F

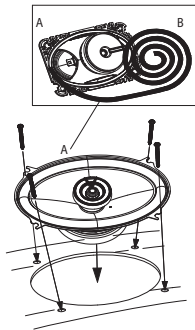
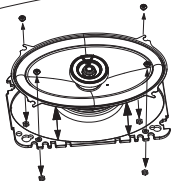
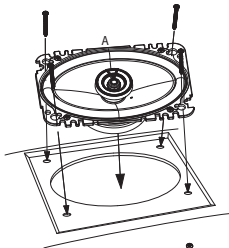
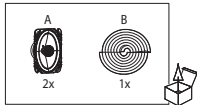
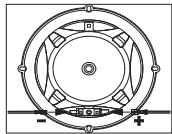

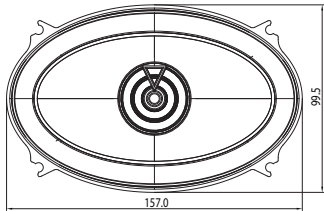
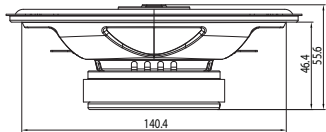

사양

- 타입: 4" x 6" (100mm x 152mm) 투웨이 차량용 스피커
- 출력 처리 용량: 40W RMS, 최대 120W
- 감도 (@ 2.83V): 92dB
- 주파수 응답: 75Hz – 20kHz
- 공칭 임피던스: 3.0 ohms

틸/스몰 파라미터

- BL (Tm): 3.296
- DCR (ohms): 2.5
- Mms (g): 7.86
- Sd (cm²): 86.59
- Cms (μm/N): 0.245
- Vas (l): 2.5977
- Fs (Hz): 114.7
- Qes: 1.303
- Qms: 12.752
- Qts: 1.182
- Crossover Point: 3kHz

Club 8622F

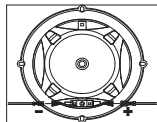
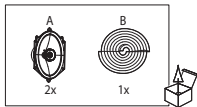
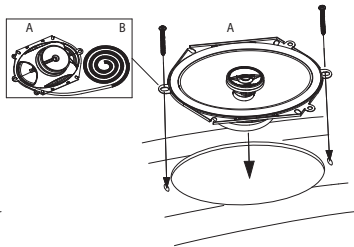
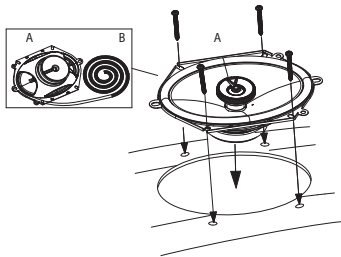

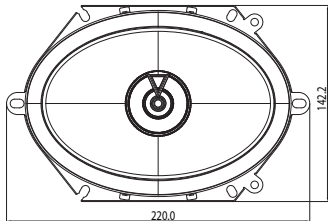
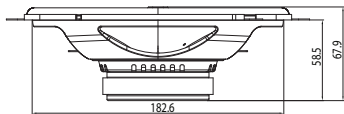

사양

- 타입: 6"x8" (152mm x 203mm) 그릴 없는 투웨이 차량용 스피커
- 출력 처리 용량: 60W RMS, 최대 180W
- 감도 (@ 2.83V): 93dB
- 주파수 응답: 65Hz – 20kHz
- 공칭 임피던스: 3.0 ohms

틸/스몰 파라미터

- BL (Tm): 3.785
- DCR (ohms): 2.39
- Mms (g): 17.718
- Sd (cm²): 165.13
- Cms (μm/N): 0.336
- Vas (l): 12.9798
- Fs (Hz): 65.2
- Qes: 1.210
- Qms: 14.592
- Qts: 1.118
- Crossover Point: 3.5kHz

Club 9632

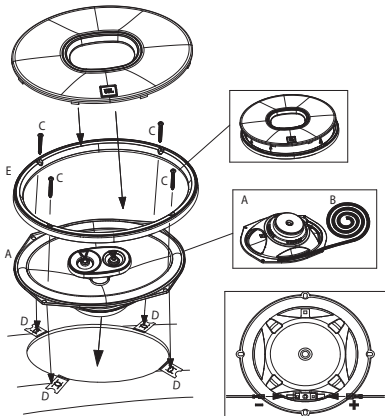
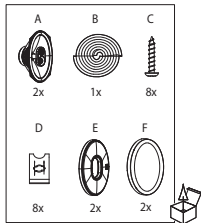

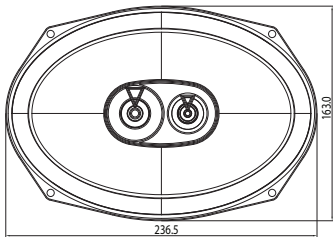
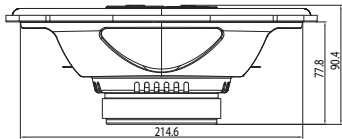

사양

- 타입: 6"x9" (152mm x 230mm) 3웨이 차량용 스피커
- 출력 처리 용량: 85W RMS, 최대 255W
- 감도 (@ 2.83V): 93dB
- 주파수 응답: 50Hz – 20kHz
- 공칭 임피던스: 3.0 ohms

틸/스몰 파라미터

- BL (Tm): 4.063
- DCR (ohms): 2.63
- Mms (g): 23.163
- Sd (cm²): 226.98
- Cms (μm/N): 0.337
- Vas (l): 24.5866
- Fs (Hz): 56.9
- Qes: 1.321
- Qms: 11.751
- Qts: 1.188
- Crossover Point: 3kHz



HARMAN International Industries,
Incorporated
8500 Balboa Boulevard, Northridge,
CA 91329 USA

© 2019 HARMAN International
Industries, Incorporated.

All Rights Reserved.

JBL은 미국 및/또는 기타 국가에 등록된 HARMAN International Industries, Incorporated의 상표입니다.

기능, 사양 및 외관은 예고 없이 변경될 수 있습니다.